

Product Introduction

This constant current LED driver adopts advanced Zigbee 3.0 wireless communication technology for intelligent lighting control. It supports dual color temperature adjustment, enabling precise control over both the color temperature and brightness to create the perfect lighting ambiance for any setting.

Features

- Color temperature and brightness adjustment
- Full AC input range, high power factor, and flicker-free performance
- Dual constant current outputs, current adjustable via DIP switch
- Overload and short-circuit protection with automatic recoveryIdeal for indoor LED lighting applications



Specification

- Product Model: PT-12A-2-WZS
- Output Voltage: 10 ~ 42VDC
- Output Current: 2x(150~450)mA
- Output Power: <12W
- Dimming Range: 0 ~ 100%
- Input Voltage: 100 ~ 240VAC, 50/60Hz
- Efficiency: $\geq 79\%$ (full load)
- Input Current: $\leq 0.15\text{A}/115\text{VAC}$ (full load)
 $\leq 0.08\text{A}/230\text{VAC}$ (full load)
- Power Factor: $\geq 0.98/115\text{VAC}$ (full load)
 $\geq 0.9\text{C}/230\text{VAC}$ (full load)
- THD: <12%/230VAC(full load)
- Standby Power: $\leq 0.5\text{W}$
- Operating Temperature: $-20^{\circ}\text{C} \sim 50^{\circ}\text{C}$
- Operating Humidity: 20 ~ 90%RH
(non-condensing)
- Storage Temperature: $-40^{\circ}\text{C} \sim 80^{\circ}\text{C}$
- Storage Humidity: 10% ~ 95%RH
- Waterproof Level: IP20
- Dimensions: 131×37×20.5mm
- Certification: CE

Wiring Diagram

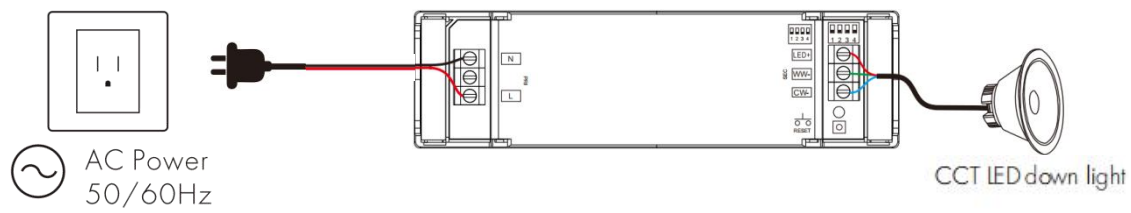

Networking method

1. Connect the wires according to the wiring diagram and plug in the power, then connect the load device.
2. Quickly press the network reset button five times (or toggle the power five times consecutively). The load light strip will blink in a breathing pattern, indicating that the device is in pairing mode.
3. Add to the network through the gateway device.

Product Dimension Diagram (mm)

